

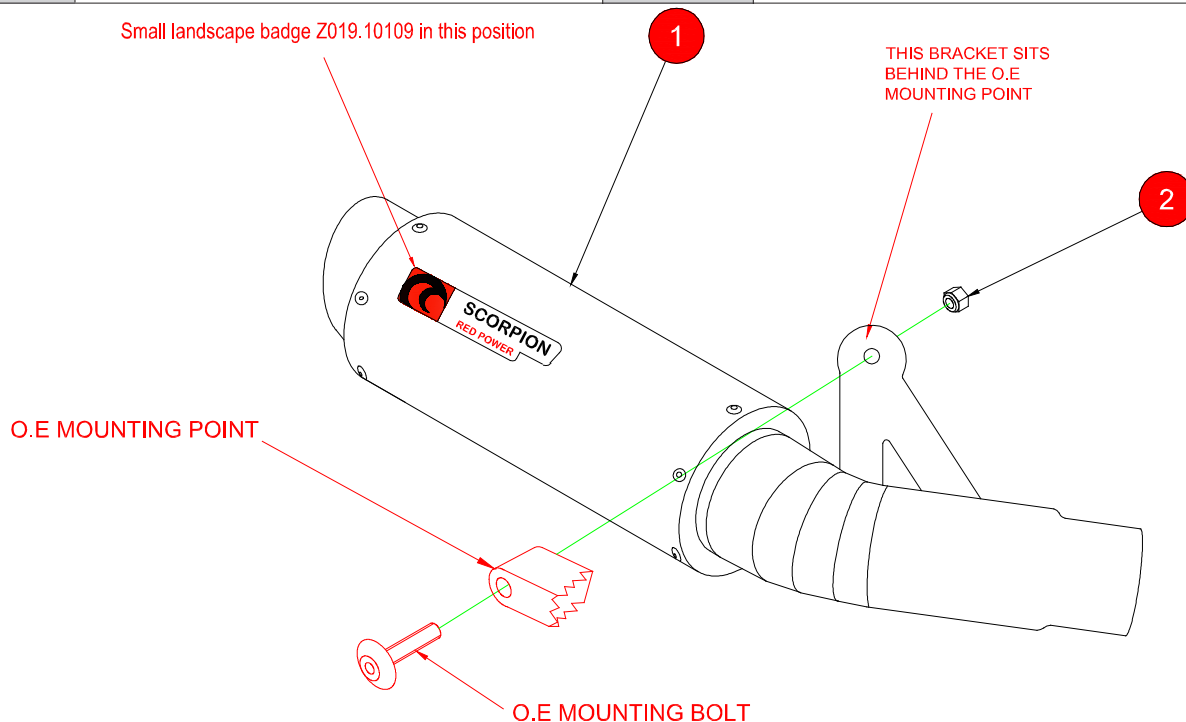

BIKE	BMW S1000 RR	PART NO.	BM1001
YEAR	2015-Current	FIT KITS	Z039.10558
NOTES	Retain for future reference	FEATURES	N/A



- 1 225mm RP-1 GP Silencer SC160 with integrated CP873
- 2 M8 Nyloc Nut (Z017.10062)

E-MARK	SC-26  2168
ISSUE NO.	0
DATE	16/09/15
AUTHORISED	T.ROWLEY
CHECKED	

NOTE: ENSURE SCORPION SYSTEM IS CLEAR OF MOVING PARTS AND ALL ORIGINAL FUNCTIONS WORK CORRECTLY.



A) Remove original exhaust from bike, taking care to keep all original components in a safe place.

B) Refit Scorpion exhaust as per line diagram above.

C) When fitted take bike for a short ride to ensure all functions are correct.

D) When bike & exhaust are cool enough check all nuts and bolts are still secure.